

TO SPECIFY FHC CONCENTRIC BIPOLAR ELECTRODES:

CATALOG # **CB 123456 (iin)**

Concentric Bipolar Electrode Configuration Length Modifier(s)

Modifier Note:
Any X's in the catalog # indicate that modifiers are required. Initials will reference a drawing with all specifics detailed.

1 Outer Pole Diameter:

Outer Pole is a stainless steel tube.

- A: 125 µm (35 ga)
- B: 200 µm (33 ga)
- C: 250 µm (31 ga)
- D: 300 µm (30 ga)
- E: 325 µm (29 ga)
- F: 400 µm (27 ga)
- G: 450 µm (26 ga)
- H: 500 µm (25 ga)
- J: 550 µm (24 ga)
- X: Special / Specify

2 Tip Configuration:

- R: Rounded, Specify Height (50% Outer Dia. Standard)
- F: Flat
- M: Microelectrode, Specify Microelectrode and extension. (100 µm standard; Ø must be > 75 µm)
- P: Pencil Point, Specify angle. (60° Standard)
- E: Extended, Specify Extension. (100 µm standard)
- B: Beveled, Specify angle. (45° Standard)
- S: Stacked, specify both inner and outer pole exposures and extension (100 µm standard on all 3)
- X: Special / Specify

50% of Outer Pole diameter height standard. (Specify other if needed.)

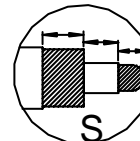
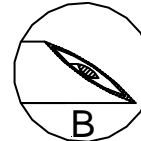
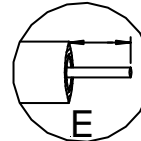
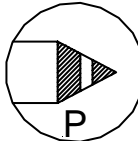
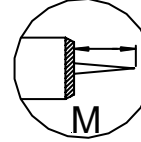
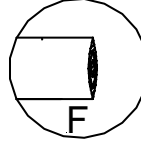
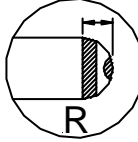

60° Angle standard. (Specify other if needed.)

100 µm standard (Specify other if needed.)

45° Angle standard. (Specify other if needed.)

100 µm exposures, 100 µm separation standard. (Specify others if needed.)

3 Inner Pole Wire Diameter:

Size / Material ; (See note on right for listing of the maximum sizes allowed for a given Outer Pole diameter.)

Note: If "M" tip configuration is chosen, the Inner Pole spec must be "X".

- B: 12.5 µm dia. Platinum/Iridium
- C: 25 µm dia. Platinum/Iridium
- D: 25 µm dia. Stainless Steel
- E: 50 µm dia. Platinum/Iridium
- F: 50 µm dia. Stainless Steel
- G: 75 µm dia. Platinum/Iridium
- H: 75 µm dia. Stainless Steel
- J: 125 µm dia. Platinum/Iridium
- K: 125 µm dia. Stainless Steel
- L: 250 µm dia. Platinum/Iridium
- M: 250 µm dia. Stainless Steel
- X: Special / Specify

Note:
Largest Inner Pole diameter allowed for Outer Pole O.D.

Outer Pole Ø: Max. Inner Pole Ø:

A:125 µm	25 µm (0.001")
B:200 µm	50 µm (0.002")
C:250 µm	75 µm (0.003")
D:300 µm	75 µm (0.003")
E:325 µm	125 µm (0.005")
F:400 µm	125 µm (0.005")
G:450 µm	200 µm (0.008")
H:500 µm	250 µm (0.010")
J:550 µm	250 µm (0.010")

4,5,6

Length (in millimeters)

75 mm Standard and in stock. See diagram below for dimension definition. No leading zero is necessary.

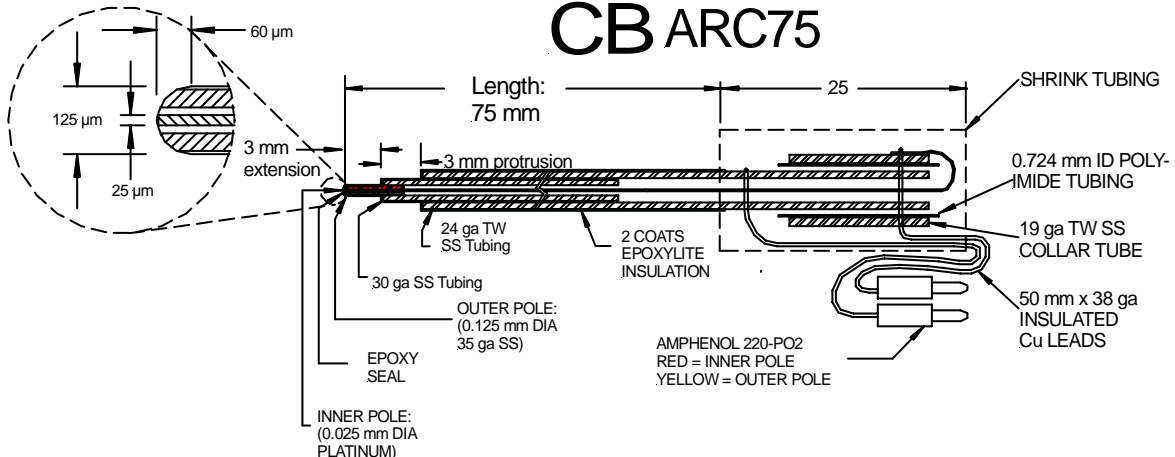

K3-78A; November 27, 2007

